

Ball Valves

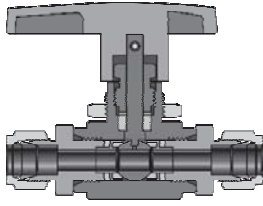

BV1 Series

Maximum working pressure up to 6000 psig (413 bar).
Working temperatures from -40 °F to 450 °F (-40 °C to 232 °C).
Available in sizes from 1/8 to 2 in. and 6 to 25mm.
Body materials: CF8M, CF3M, CF8, and CF3/A351.
Seat materials: PTFE, PCTFE, and PEEK.
CIR-LOK provide 2-way straight, 2-way angle, and 3-way patterns.
Orifice sizes from 2.4 mm to 10.6 mm.

Pressure-Temperature Ratings

Body Material	316 stainless steel		
Seat Material	PCTFE	PTFE	PEEK
Temperature, °F (°C)	Working Pressure, psig (bar)		
-20 (-28) to 100 (37)	6000 (413)	1500 (103)	6000 (413)
200 (93)	2000 (137)	750 (151.5)	5000 (344)
300 (148)	-	-	3200 (220)
400 (204)	-	-	1400 (96.4)
450 (232)	-	-	500 (34.4)

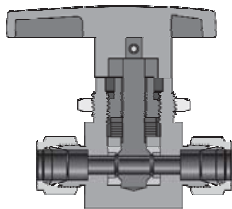

BV2 Series

One-piece ball valves.
Maximum working pressure up to 3000 psig (206 bar).
Working temperatures from -65 °F to 300 °F (-54 °C to 148 °C).
Maximum working pressure up to 3000 psig (207 bar).
Orifice sizes from 1.3 mm to 10.3 mm.
Body materials: 316, 316L, 304, 304L/A479 alloy 400/B164, and brass CDA/B16.
Seat materials: PTFE, RPTFE, and UHMWPE.
CIR-LOK provide 2-way, 3-way, 4-way, 5-way, 6-way, and 7-way flow patterns.

Pressure-Temperature Ratings

Body Material	316 stainless steel
Seat Material	Modified PTFE
Temperature, °F (°C)	Working Pressure, psig (bar)
-65 (-53) to 50 (10)	2500 (172)
200 (93)	2500 (172)
300 (148)	2500 (172)

BV3 Series

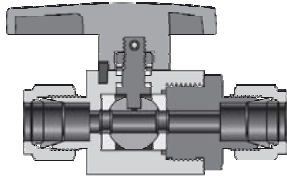

Maximum working pressure up to 1000 psig (68 bar).
Working temperatures from -40 °F to 450 °F (-40 °C to 232 °C).
Body materials: 316 , 304 , 321/A479, and brass CDA/B16.
Seat material: PTFE
Orifice sizes from 4.8 mm to 19.1mm

Pressure-Temperature Ratings

Body Material	316 stainless steel
Seat Material	PTFE
Temperature, °F (°C)	Working Pressure, psig (bar)
-40 (-40) to 100 (37)	1000 (68)
200 (93)	1000 (68)
300 (148)	800 (55.1)
400 (204)	330 (22.7)
450 (232)	100 (6.8)

BV4 Series

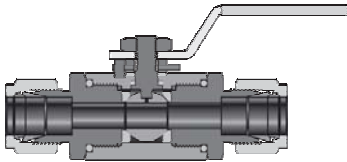

Maximum working pressure: 10 000 psig (688 bar).
Working temperatures: -40 °F to 450 °F (-40 °C to 232 °C).
Body materials: 316, 304/A479.
Seat materials: PCTFE and PEEK.
CIR-LOK provide 2-way and 3-way flow patterns.
Orifice sizes from 10 mm to 19.1 mm.

Pressure-Temperature Ratings

Body Material	316 stainless steel
Seat Material	PEEK
Temperature, °F (°C)	Working Pressure, psig (bar)
-40 (-40) to 100 (37)	10000 (413)
200 (93)	5000 (344)
300 (148)	3200 (220)
400 (204)	1400 (96.4)
450 (232)	500 (34.4)

BV5 Series

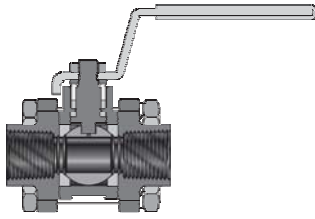

3-piece precision cast body construction.
Working pressure up to 1000 psig (68 bar).
Working temperatures from -65°F to 450°F (-54°C to 232°C).
Body materials: CF8M , CF3M, CF8 ,
and CF3/A351.
Seat material: PTFE.
Orifice sizes from 10.6 mm to 76 mm.

Pressure-Temperature Ratings

Body Material	316 stainless steel
Seat Material	PTFE
Temperature, °F (°C)	Working Pressure, psig (bar)
-65 (-53) to 100 (37)	1000 (68)
200 (93)	1000 (68)
300 (148)	800 (55.1)
400 (204)	330 (22.7)
450 (232)	100 (6.8)

BV6 Series

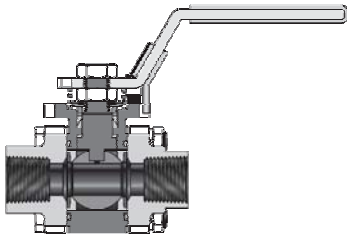

3-piece precision cast body construction.
Maximum working pressure up to 3000 psig (206 bar).
Working temperatures from -65°F to 550°F (-54°C to 287°C).
Body materials: CF8M (316), CF3M (316L), CF8 (304),
and CF3 (304L).
Seat materials: PTFE, RPTFE, PEEK,UHMWPE and Alloy X-750
Orifice sizes from 10.6 mm to 50 mm.

Pressure-Temperature Ratings

Body Material	316 stainless steel		
Seat Material	Reinforced PTFE	Virgin PTFE	PEEK
Temperature, °F (°C)	Working Pressure, psig (bar)		
-20 (-28) to 100 (37)	2200 (151)	1500 (103)	3000 (206)
200 (93)	1500 (103)	1500 (103)	1870 (128)
300 (148)	800 (55.1)	800 (55.1)	1600 (110)
400 (204)	330 (22.7)	330 (22.7)	1260 (86.8)
450 (232)	100 (6.8)	100 (6.8)	800 (55.1)

BV7 Series

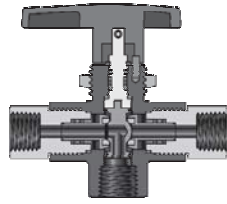

Working pressure up to 10 000 psig (688 bar).
Working temperatures from -40 °F to 450 °F (-40 °C to 232 °C).
Body materials: 316, 316L/A182, and alloy 400/B167.
Seat materials: PTFE, PCTFE, and PEEK.
Orifice size is 4.8 mm.

Pressure-Temperature Ratings

Body Material	316 stainless steel
Seat Material	PEEK
Temperature, °F (°C)	Working Pressure, psig (bar)
-40 (-40) to 100 (37)	10000 (413)
200 (93)	5000 (344)
300 (148)	3200 (220)
400 (204)	1400 (96.4)
450 (232)	500 (34.4)

BV8 Series

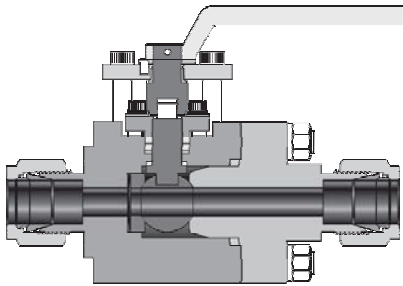

Maximum working pressure up to 6000 psig (414 bar).
Working temperatures from -20 °F to 1500 °F (-29 °C to 816 °C).
Body materials: 316, 304, 321, F22, F91, Duplex 2205, Duplex 2507/A182, Inconel 600/B166.
Advanced HVOF treated with Ball seat surface or stellite.
Orifice sizes from 10.6 mm to 38.1 mm.

Pressure-Temperature Ratings

Body Material	316 stainless steel
Temperature, °F (°C)	Working Pressure, psig (bar)
-65 (-53) to 100 (37)	6000 (413)
200 (93)	5260 (355)
300 (148)	4660 (321)
400 (204)	4280 (294)
500 (260)	3980 (274)
600 (315)	3760 (259)
700 (371)	3600 (248)
800 (426)	3460 (236)
900 (482)	3220 (221)
1000 (537)	3030 (208)
1100 (593)	2685 (184)
1200 (648)	1715 (118)

How to Order

BV1 — M12 — FNPT8 — P10 — R — Y3 — 316

Series	Port 1 type	Port 1 Size	Port 2/3 Type	Port 2/3 Size	Seat Material	Orifice Size	Packing Material	Handle	Flow Pattern	ASME Class	Body Material
BV1	FNPT Female NPT	2 1/8 in.	Same as Port 1		T PTFE	02 0.093 in. (2.4 mm)	V Fluorocarbon FKM	B Black	S Straight	CL1 Class 150	CF8M/316
BV2	NPT Male NPT	3 3 mm			K PCTFE	03 0.125 in. (3.2 mm)	G Graphite	R Red	A Angle	CL3 Class 300	CF3M/316L
BV3	FBT Female BSPT	4 1/4 in.			P PEEK	04 0.165 in. (4.2 mm)	P PEEK	G Green	3D 3-way Diverter model	CL6 Class 600	CF8/304
BV4	MBT Male BSPT	5 5/16 in.			R Reinforced PTFE	05 0.187 in. (4.7 mm)	R RPTFE	B Blue		CL9 Class 900	CF3/304L
BV5	FMS Female ISO 261 (for BG)	6 3/8 in. or 6 mm			F Body material-HOFV31	06 0.250 in. (6.4 mm)	T PTFE	Y Yellow	3S 3-way Selector model	CL15 Class 1500	Brass
BV6	MS Male ISO 261 (for BG)	8 1/2 in. or 8 mm			I Inconel 718	10 0.406 in. (10.3 mm)				CL25 Class 2500	Alloy400
BV7	FBP Female BSPP (for BP)	10 10 mm			W Stellite	13 0.5 in. (12.7 mm)			3 3-way		F22
BV8	MBG Male BSPP (for BG)	12 3/4 in. or 12 mm				19 0.75 in. (19.0 mm)			4 4-way		F91
	F Fractional Tube Fitting	14 14 mm				22 0.875 in. (22.2 mm)			5 5-way		Duplex
	M Metric Tube Fitting	16 1 in. or 16 mm				. . .			6 6-way		Duplex 2507
	MSW Metric Tube Socket Weld	18 18 mm				. . .			7 7-way		Alloy 600
	FSW Fractional Tube Socket Weld	20 20 mm				. . .					Steel
	MBW Metric Tube Butt Weld	22 22 mm				. . .					
	FBW Fractional Tube Butt Weld	24 1 1/2 in.				. . .					
	PSW Pipe Socket Weld	25 25 mm				. . .					
	PBW Pipe Butt Weld	27 M27 x 2				. . .					
	FNGN Nut + Gasket + Bulge Fractional Tube Nipple	28 28 mm				. . .					
	MNGN Nut + Gasket + Metric Tube Bulge Nipple	32 2 in. or 32 mm				. . .					
		36 2 1/4 in.				. . .					
		40 2 1/2 in.				. . .					
		48 3 in.				. . .					
		64 4 in.				. . .					