

Check Valves

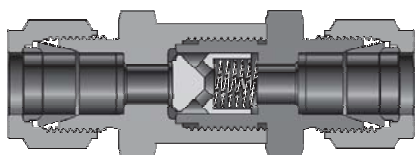

CV1 Series

Maximum working pressure up to 3000 psig (206 bar).
Working temperatures from -10°F to 375°F (-23°C to 190°C).
Cracking pressures from 1/3 to 25 psig (0.02 to 1.7 bar).
CIR-LOK provided stainless steel, brass, carbon steel, and alloy body materials.

Pressure-Temperature Ratings

Body Material	316 stainless steel	Brass
Seat Material	FKM	Buna-N
Temperature, °F (°C)	Working Pressure, psig (bar)	
-10 (-23) to 100 (37)	3000 (206)	3000 (206)
200 (93)	2575 (177)	2600 (179)
250 (121)	2450 (168)	2405 (165)
300 (148)	2325 (160)	-
375 (190)	2185 (150)	-

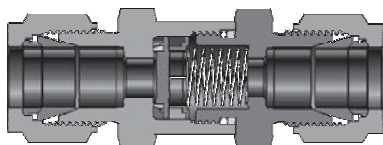

CV2 Series

Maximum working pressure up to 6000 psig (413 bar).
Working temperatures from -10°F to 400°F (-23°C to 204°C).
Cracking pressures from 1/3 to 25 psig (0.02 to 1.7 bar).
CIR-LOK provided stainless steel, brass, carbon steel, and alloy body materials.

Pressure-Temperature Ratings

Body Material	316 stainless steel
Seat Material	FKM
Temperature, °F (°C)	Working Pressure, psig (bar)
-10 (-23) to 100 (37)	6000 (413)
200 (93)	5260 (355)
300 (148)	4660 (321)
400 (190)	4280 (294)

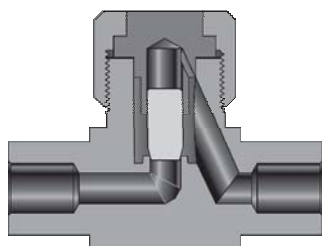

CV3 Series

Union bonnet design
CV3 series valves must be mounted horizontally, with bonnet nut on top.
Maximum working pressure up to 6000 psig (413 bar).
Working temperatures from -65°F to 900°F (-54°C to 482°C).
Materials: stainless steel, brass, carbon steel, and alloy.

Pressure-Temperature Ratings

Body Material	316 stainless steel
Temperature, °F (°C)	Working Pressure, psig (bar)
-65 (-53) to 100 (37)	6000 (413)
200 (93)	5260 (355)
300 (148)	4660 (321)
400 (204)	4280 (294)
500 (260)	3980 (274)
600 (315)	3760 (259)
700 (371)	3600 (248)
800 (426)	3460 (236)
900 (482)	3280 (225)

How to Order

CV1 — F8 — M10 — N — 1 — 316

Series	Inlet Type	Inlet Size	Outlet Type	Outlet Size	Seal Material	Cracking Pressure	Body Material
CV1	FNPT Female NPT	2 1/8 in.	Same as Inlet		V Fluorocarbon FKM	1 1 psig	316
CV2	NPT Male NPT	4 1/4 in.			B Buna N	2 1/3 psig	316L
CV3	FBT Female BSPT	6 3/8 in. or 6 mm			E Ethylene propylene	3 3 psig	304
	MBT Male BSPT	8 1/2 in. or 8 mm			N Neoprene	10 10 psig	304L
	FMS Female ISO (for BP)	10 10 mm			Z Kalrez	25 25 psig	Alloy 20
	MS Male ISO (for BG)	12 3/4 in. or 12 mm					Alloy 400
	FBP Female BSPP (for BP)	14 14 mm					Alloy 600
	MBG Male BSPP (for BG)	16 1 in. or 16 mm					Alloy C-276
	FSW Fractional Tube Socket Weld	18 18 mm					Brass
	MSW Metric Tube Socket Weld	20 1 1/4 in. or 20 mm or					Steel
	FBW Fractional Tube Butt Weld	22 22 mm					Duplex 2507
	MBW Metric Tube Butt Weld	25 25 mm					Titanium
	PSW Pipe Socket Weld						
	PBW Pipe Butt Weld						
	F Fractional Tube Fitting						
	M Metric Tube Fitting						
	FNGN Nut + Gasket + Fractional Bulge Nipple						
	MNGN Nut + Gasket + Metric Bulge Nipple						
	MOFS Male OFS Fitting						
	FGFS Female GFS Fitting						
MGFS Male GFS Fitting							
RGFS Rotatable Male GFS Fitting							